

	Period 1	Period 2	Period 3	Lunch	Period 4	Period 5	Period 6
Room A (capacity: 8)	French 2 J. Cormack	English 2 J. Cormack	English 1 J. Cormack		Biology TBA	Physical Sci TBA	Chemistry TBA
Room B (capacity 8-10)	Keyboarding/ Computer Applications (Middle School level) A. Woodall	US History A. Woodall	World History A. Woodall		World Religion J. Woodall	Debate A. Woodall	Keyboarding/ Computer Applications (High School level) A. Woodall
Room C (capacity 12)	Navigator 1 Crafts Brooks	Navigator 1 History Altman	Navigator 2 History Altman		Navigator 1 Grammar Games Brooks	Navigator 2 Crafts Brooks	Writers Workshop Melton
Room D (capacity 8-10)		Navigator 2 Science Tueni	Navigator 1 Science Tueni		Latina Christiana 1 (Surveyors or Navigators 2) New Hire	Prima Latina (Navigators 1 or 2) New Hire	Spanish 1 New Hire
Room E (capacity 9-13)	Navigator 2 Writing Guthrie	Surveyors History Guthrie	Surveyors Writing Guthrie		Writers Workshop Melton	Surveyors Literature Guthrie	Surveyors General Sci Guthrie
Room F (capacity 6)					Art J. Cormack	Art J. Cormack	Art J. Cormack
	Study Hall	Study Hall	Study Hall				

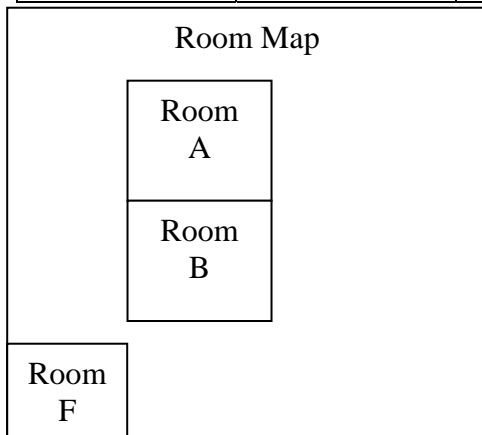

Bell Schedule:

8:15-8:30	Faculty Prayer time	8:15-8:30	Faculty Prayer time
8:30-8:40	Chapel-All Students	8:30-8:40	Chapel-All Students
8:40-9:40	Period 1	8:40-9:40	Period 1
9:45-10:45	Period 2	9:45-10:45	Period 2
10:50-11:50	Period 3	10:50-11:50	Period 3
11:50-12:30	Lower School Lunch	11:55-12:55	Period 4
12:30-1:30	Period 4	12:55-1:30	Upper School Lunch
1:35-2:35	Period 5	1:35-2:35	Period 5
2:40-3:40	Period 6	2:40-3:40	Period 6